

# CCM



EUROPE  
PRODUCT CATALOGUE

# S2 | 24

# 125 YEARS

## CHAPTER 1: THE FIRST 125 YEARS.

WE'VE SEEN MANY GOALS OVER THE LAST 125 YEARS, BUT ONE STANDS ABOVE ALL THE OTHERS: CCM'S GOAL TO BE THE LEADING HOCKEY BRAND ON AND OFF THE ICE, BY WORKING DILIGENTLY TO PRODUCE INNOVATIVE PRODUCTS FOR EVERY PLAYER, AT EVERY LEVEL.

WE ARE PROUD OF OUR JOURNEY THUS FAR, BUT OUR ULTIMATE GOAL IS FOR EVERY PLAYER TO FEEL EMPOWERED IN THE LOCKER ROOM, FEEL STRONG IN THEIR GEAR, AND FEEL AT HOME ON THE ICE. WE'RE JUST GETTING STARTED.

## ONTO THE NEXT CHAPTER.

### WEBSITE

CCMHOCKEY.COM

### TO START YOUR B2B ONLINE SHOPPING, GO TO

WWW.GO2CCMHOCKEY.COM AND CLICK ON "REQUEST LOGIN".

FIND US ON  
SOCIAL  
MEDIA



CCMHOCKEY



@CCMHOCKEY



CCMHOCKEY



@CCM.HOCKEY



CCMHOCKEY

## HEAD OFFICE LOCATIONS

### NORTH AMERICA

CCM HOCKEY  
8275 TRANS-CANADA HIGHWAY,  
BUREAU B110  
MONTRÉAL, QUÉBEC  
H4S 0B6, CANADA  
TEL.: (800) 636-5895  
FAX: (800) 636-5751

### EUROPE

CCM HOCKEY AB  
GÅRDSVÄGEN 13  
SE 16970 SOLNA  
SWEDEN  
TEL.: + 46 (0) 8 522 352 00  
FAX: + 46 (0) 8 522 352 10

© 2024 SPORT MASKA INC. ALL RIGHTS RESERVED. CCM, TACKS, RIBCOR, EFLEX AND RELATED LOGOS ARE TRADEMARKS OF SPORT MASKA INC. MAY NOT BE REPRODUCED WITHOUT THE PRIOR WRITTEN CONSENT OF SPORTS MASKA INC.

NHL AND THE NHL SHIELD ARE REGISTERED TRADEMARKS OF THE NATIONAL HOCKEY LEAGUE. ALL NHL LOGOS AND MARKS AND TEAM LOGOS AND MARKS DEPICTED HEREIN ARE THE PROPERTY OF THE NHL AND THE RESPECTIVE TEAMS AND MAY NOT BE REPRODUCED WITHOUT THE PRIOR WRITTEN CONSENT OF NHL ENTERPRISES, L.P. © NHL 2024. ALL RIGHTS RESERVED. © PHOTOS: GETTY IMAGES.

† : THIS CATALOG MAY REFER TO THE FOLLOWING TRADEMARKS WHICH ARE OWNED BY THE COMPANIES WHOSE NAMES APPEAR AFTER THE TRADEMARK: AHL - AMERICAN HOCKEY LEAGUE; CLARINO - HURARAY CO. LTD.; CHL - CANADIAN HOCKEY LEAGUE; LYCRA, SPANDEX AND SURLYN - E.I. DUPONT DE NEMOURS AND COMPANY; ECHL - ECHL INC.; PLAYDRY - REEBOK INTERNATIONAL LTD; TACTEL - INVISTA; VELCRO - VELCRO INDUSTRIES B.V.; THINSULATE IS A TRADEMARK OF 3M, USED UNDER LICENSE IN CANADA; D30® - DESIGN BLUE LTD.; JETSPED - TAYLORMADE GOLF COMPANY INC.; SIGMATEX - SIGMATEX (UK) LIMITED; POLYGIENE - POLYGIENE AB; FLUID INSIDE - MIPS AB. - ORTHOLITE® - ORTHOLITE.

WARNING : HOCKEY IS A DANGEROUS COLLISION SPORT. WE RECOMMEND THAT PROTECTIVE EQUIPMENT AND A CERTIFIED HELMET BE WORN AT ALL TIMES.

SPORT MASKA INC. RESERVES THE RIGHT TO CHANGE ALL PRODUCT SPECIFICATIONS AND/OR CUSTOM PROGRAMS. WHILE THE INFORMATION SHOWN IN THIS PUBLICATION WAS CORRECT AT THE TIME OF PRINTING, WE RESERVE THE RIGHT TO DISCONTINUE THE SALE OF PRODUCT OR CHANGE SPECIFICATIONS OR DESIGNS WITHOUT NOTICE OR OBLIGATION. COPYRIGHT © SPORT MASKA INC. 2024. ALL RIGHTS RESERVED. PRINTED IN CANADA. 🍁

## PLAYER STICKS

RIBCOR .....	6-8
TACKS .....	10-11
JETSPEED .....	12-15
TEAM .....	16-17
STREET .....	18
STICKS ACCESSORIES.....	18
STICKS CURVES.....	19
STICKS ARCHITECTURE.....	19







# CCM PERFORMANCE LAB

## RESEARCH AND RETAIL DEVELOPMENT

AT CCM, WE ARE ALWAYS LOOKING TO PUSH INNOVATION. THE STICK CATEGORY RELIES ON ADVANCES IN MECHANICAL ENGINEERING TO ALLOW DATA DRIVEN PERFORMANCE.

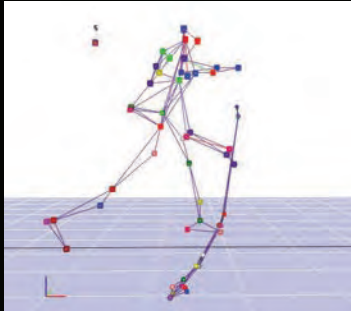

**62**

R&D STUDIES

**41 288**

SHOTS ANALYSED

**3 220**

SLASHING/PASSING/STICKHANDLING TASKS ANALYSED

**553**

PLAYERS

**50**

NHL PROS

**128**

NHL PROSPECTS

# NANOLITE SHIELD

INTRODUCING CCM'S LATEST INNOVATION, NANOLITE SHIELD MAXIMIZES THE USE OF CARBON LAYERS IN VARYING THICKNESSES TO ACHIEVE DRASTIC WEIGHT REDUCTION WITHOUT COMPROMISING DURABILITY.

THE REENGINEERED CORE OF CCM'S STICK SHAFTS NOW INCORPORATES EXTREMELY LIGHT CARBON FIBER LAYERS STACKED BETWEEN TWO THICKER, STONGER LAYERS TO ALLOW FOR IMPORTANT WEIGHT SAVINGS. WITH AN OUTER SHIELD COMPOSED OF UNIDIRECTIONAL CARBON FIBERS AND OUR ELITE SIGMA STP WEAVE, THE STICK IS PROTECTED FROM IN-GAME IMPACTS.

THIS NEW DESIGN ENABLES THE STICK TO BE AS DURABLE AS ITS PREDECESSOR, ALL WHILE REDUCING WEIGHT BY AS MUCH AS 15 GRAMS.

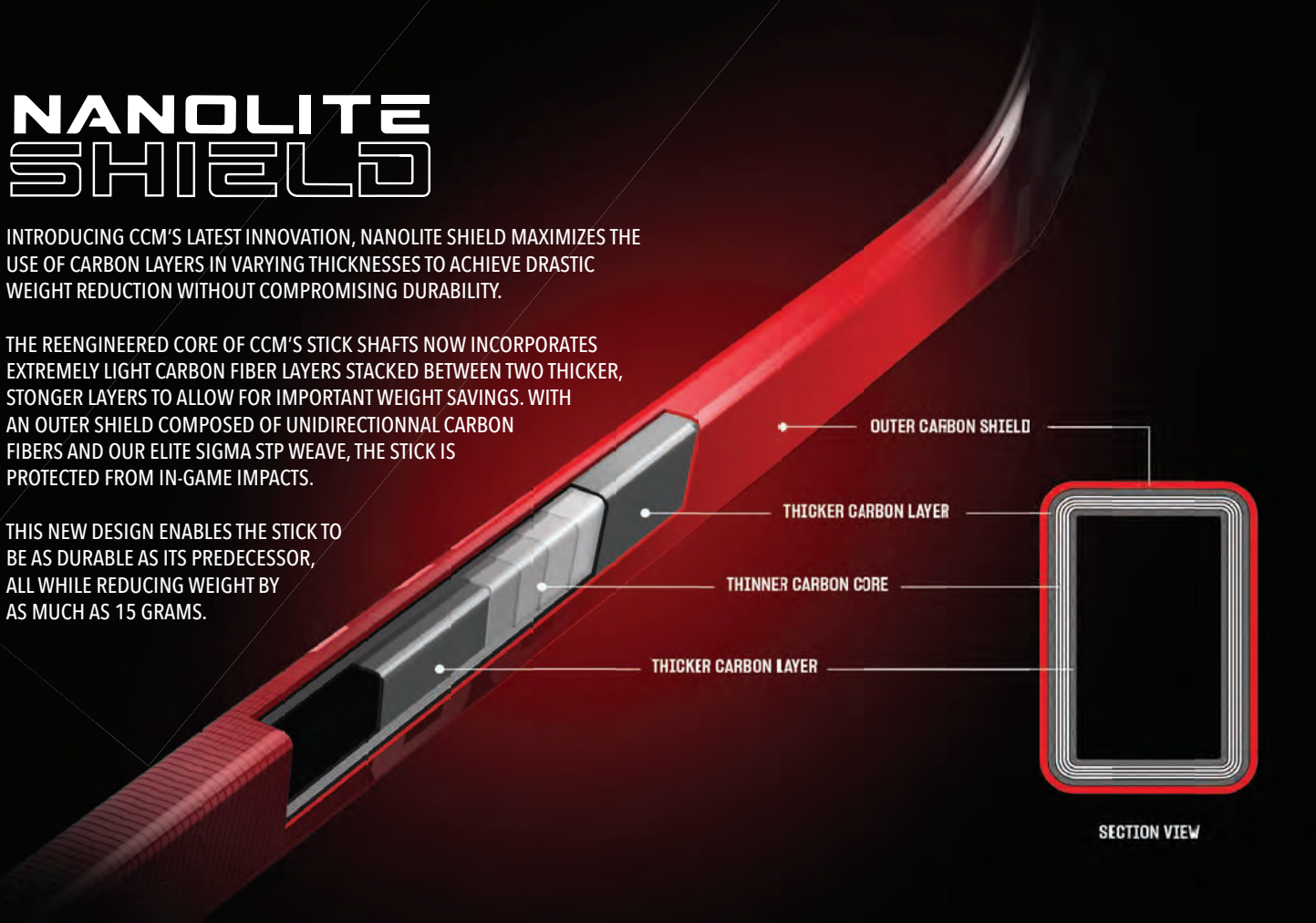

OUTER CARBON SHIELD

THICKER CARBON LAYER

THINNER CARBON CORE

THICKER CARBON LAYER



SECTION VIEW

# DUALFEEL TECHNOLOGY

CCM'S NEW DUAL FEEL TECHNOLOGY TAKES PUCK FEEL TO A WHOLE NEW LEVEL

AS MODERN HOCKEY TECHNIQUES PROMOTE THE USE OF THE MID AND TOE SECTIONS OF THE BLADE FOR SHOOTING AND ITS HEEL FOR STICKHANDLING AND PASSING, CCM HAS LOCALLY OPTIMIZED BOTH TO CREATE A STICK WHERE LIGHTNING-QUICK RELEASES NOW MEET UNBELIEVABLE FEEL

LEVERAGING AN INNOVATIVE DAMPENING FOAM INSERT IN THE HEEL OF THE BLADE'S INTERNAL CONSTRUCTION, CCM'S DUAL-FEEL TECHNOLOGY BETTER DAMPENS VIBRATIONS AND IMPROVES ITS ACOUSTICS WHEN STICKHANDLING AND PASSING THE PUCK.

PRESERVING OUR PROVEN FOAM CORE IN THE MID AND TOE SECTIONS, UNDER A SIGMA ST<sup>®</sup> CARBON WEAVE, THEN ENSURES PLAYERS STILL BENEFIT FROM THE ICONIC RIBCOR QUICK RELEASE.



NEW DAMPENING  
FOAM INSERT

ADVANCED  
FOAM CORE

SIGMA ST<sup>®</sup>  
CARBON WEAVE



CCM'S PATENTED ELITE BLADE TECHNOLOGY FOR SUPERIOR DURABILITY AND LONGER-LASTING POP.

ACHIEVED THROUGH THE USE OF CARBON LAYERS OPTIMALLY ANGLED IN SMALLER INCREMENTS THAN EVER BEFORE, THIS NEW DESIGN HELPS BETTER DISSIPATE ENERGY COMING FROM IN-GAME IMPACTS, THUS ALLOWING THE BLADE TO KEEP ITS INTEGRITY OVER A LONGER PERIOD OF TIME.

COMBINED WITH OUR SIGMA ST<sup>®</sup> CARBON WEAVE, THE HELICOID TECHNOLOGY ENABLES PLAYERS TO EXPERIENCE EXCEPTIONAL SHOOTING PERFORMANCE, SHOT AFTER SHOT.

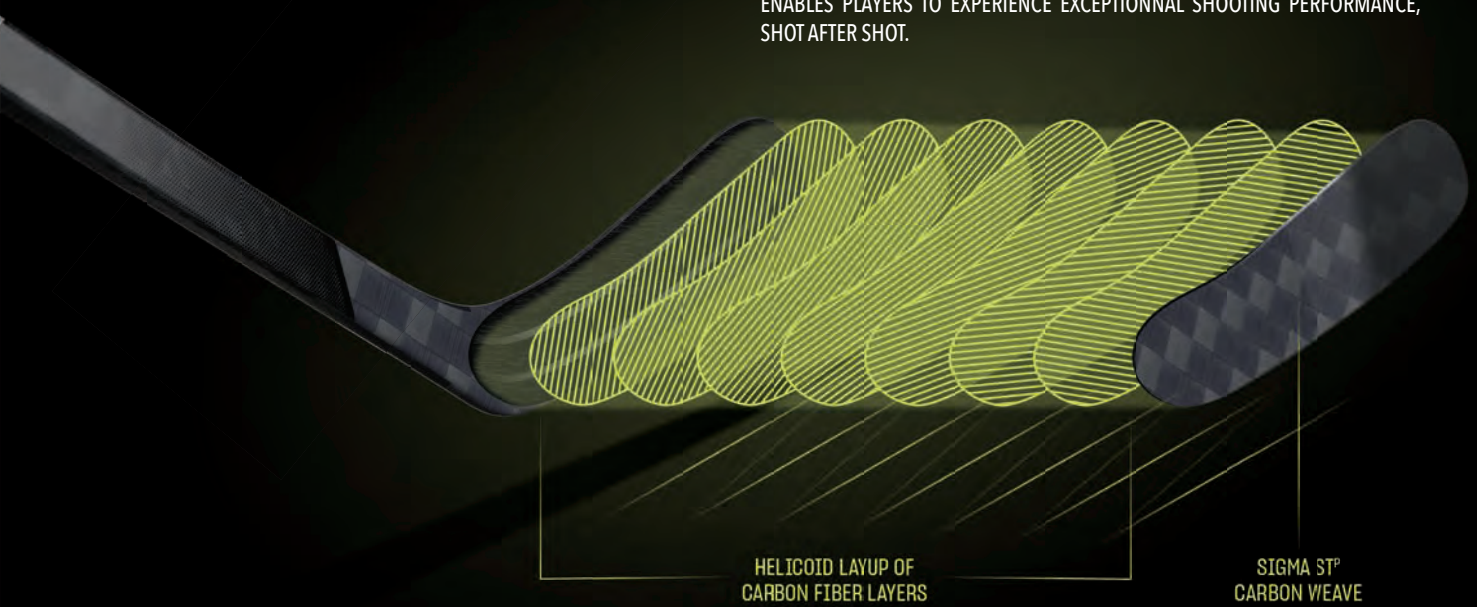

HELICOID LAYUP OF  
CARBON FIBER LAYERS

SIGMA ST<sup>®</sup>  
CARBON WEAVE

# RIBCOR TRIGGER 9 PRO STICK

THE 2024 RIBCOR TRIGGER 9 PRO HAS AGAIN REACHED NEW HEIGHTS. WITH ITS ADVANCED TECHNOLOGY AND DESIGN BASED ON THE SUCCESS AND PERFORMANCE OF PREVIOUS YEARS, IT IS SURE TO GIVE PLAYERS THE EDGE THEY NEED TO DOMINATE ON THE ICE. WITH ITS NOTORIOUS 'E' SHAPE GEOMETRY AND ITS IMPROVED LOW KICKPOINT, RIBCOR STICKS MAKE IT EASY FOR PLAYERS TO LOAD THE PUCK AND RELEASE IT QUICKLY AND WITH PRECISION.

BUT THAT'S NOT ALL - RIBCOR NOW BOASTS OUR PROVEN HELICOID TECHNOLOGY THAT ENSURES THAT THE BLADE MAINTAINS ITS INTEGRITY LONGER, EVEN WITH REPEATED USE. IN SYMBIOSIS WITH OUR DUAL-FEEL TECHNOLOGY, PLAYERS CAN RELY ON THEIR STICK TO PROVIDE INCREDIBLE FEEL AND ACCOUSTICS, BUT ALSO TO PERFORM CONSISTENTLY OVER TIME, WITHOUT WORRYING ABOUT WEAR AND TEAR. THESE STICKS ARE SURE TO TAKE YOUR GAME TO THE NEXT LEVEL.

## TECH 001

### OPTIMIZED LOW KICKPOINT

REVISED KICKPOINT PROFILE WITH SOFTER HOSEL AND TOP SHAFT MAKING YOUR SHOTS EASIER TO LOAD.

## TECH 002

### NANOLITE SHIELD CARBON LAYERING TECHNOLOGY

HIGH-PERFORMANCE CARBON LAYERING TECHNOLOGY WHICH CREATES A STICK THAT'S BOTH INCREDIBLY LIGHT AND INCREDIBLY STRONG.

## TECH 003

### HELICOID BLADE WITH DUAL-FEEL

INCREASED PERFORMANCE, FEEL AND DURABILITY WITH THE COMBINATION OF HELICOID & DUAL FEEL.

## TECH 004

### SIGMA ST<sup>P</sup> CARBON

SIGMATEX'S TOP PERFORMANCE WEAVE FOR WEIGHT REDUCTION AND DURABILITY.

PRODUCT HAS A HOLOGRAPHIC FINISH,  
COLORS MAY VARY FROM THE PICTURE





NEW

# HSRC9P RIBCOR TRIGGER 9 PRO STICK

SR \$ \_\_\_\_\_  
INT \$ \_\_\_\_\_  
JR \$ \_\_\_\_\_  
YT \$ \_\_\_\_\_

NAMEBAR TAG

**KICKPOINT**  
**OPTIMIZED LOW KICKPOINT**  
Revised kickpoint profile with softer hosel and top shaft making your shots easier to load.

**SHAFT TECHNOLOGY**  
**NANOLITE SHIELD CARBON LAYERING TECHNOLOGY**  
High-performance carbon layering technology which creates a stick that's both incredibly light and incredibly strong.

**SHAFT GEOMETRY**  
**ERGONOMIC "E" GEOMETRY**  
Unique ergonomic geometry designed to offer a seamless energy transfer to maximize speed of release.

**TAPER TECHNOLOGY**  
**SKELETON +**  
Manufacturing technology found in the taper area which provides better reliability in key moments of the game.

**BLADE**  
**DUAL-FEEL BLADE WITH HELICOID**  
Earn performance, feel and durability with the combination of Helicoid & Dual feel.

**GRIP**  
**TRIGGER MICROFEEL**  
Updated Trigger curved raised grip to enhance stick feel in hands.

**MATERIAL**  
**SIGMA STP SPREAD TOW SHAFT AND BLADE**  
Sigmatex's top performance weave for weight reduction and durability.

### OFFERING

SR - 95 / 62"	INT - 65 / 57"
P28 / P29	P28 / P29 / P90TM
SR - 85 / 60"	INT - 55 / 55"
P28 / P29 / P90TM	P28 / P29 / P90TM
SR - 80 / 60"	JR - 50 / 54"
P28 / P29 / P90TM	P28 / P29 / P90TM
SR - 75 / 60"	JR - 40 / 51"
P28 / P29 / P90TM	P28 / P29 / P90TM
SR - 70 / 60"	YT - 30 / 48"
P28 / P29 / P90TM	P28

**BOOKING ONLY**  
SR ONLY - 85 / 80 / 75 / 70  
P28M / P29M

PRODUCT HAS A HOLOGRAPHIC FINISH, COLORS MAY VARY FROM THE PICTURE

HSRC9P - LAUNCH DATE

NEW

# HSRC9K RIBCOR TRIGGER 9K STICK

SR \$ \_\_\_\_\_  
INT \$ \_\_\_\_\_  
JR \$ \_\_\_\_\_

NAMEBAR TAG

**KICKPOINT**  
**OPTIMIZED LOW KICKPOINT**  
Revised kickpoint profile with softer hosel and top shaft making your shots easier to load.

**SHAFT TECHNOLOGY**  
**ADVANCED CARBON MATRIX**  
Performance carbon layering technology now combined with Sigmatex spread tow to offer a lighter yet even more durable stick.

**SHAFT GEOMETRY**  
**ERGONOMIC "E" GEOMETRY**  
Unique ergonomic geometry designed to offer a seamless energy transfer to maximize speed of release.

**TAPER TECHNOLOGY**  
**SKELETON +**  
Manufacturing technology found in the taper area which provides better reliability in key moments of the game.

**BLADE**  
**AGILITY BLADE WITH PEEL-PLY**  
A thinner profile blade that takes stick handling and feel to the next level without any compromise on shots release speed.

**GRIP**  
**TRIGGER MICROFEEL 2**  
Trigger curved raised grip to enhance stick feel in hands.

**MATERIAL**  
**SIGMATEX SPREAD TOW SHAFT AND BLADE**

### OFFERING

SR - 95 / 62"	INT - 65 / 57"
P28 / P29	P28 / P29 / P90TM
SR - 85 / 60"	INT - 55 / 55"
P28 / P29 / P90TM	P28 / P29 / P90TM
SR - 80 / 60"	JR - 50 / 54"
P28 / P29 / P90TM	P28 / P29 / P90TM
SR - 75 / 60"	JR - 40 / 51"
P28 / P29 / P90TM	P28 / P29 / P90TM
SR - 70 / 60"	
P28 / P29 / P90TM	

PRODUCT HAS A HOLOGRAPHIC FINISH, COLORS MAY VARY FROM THE PICTURE

HSRC9K - LAUNCH DATE

**NEW**  
HSRC9  
**RIBCOR**  
**TRIGGER 9**  
STICK

SR \$ \_\_\_\_\_  
INT \$ \_\_\_\_\_  
JR \$ \_\_\_\_\_  
**NAMEBAR TAG**

**KICKPOINT**  
**OPTIMIZED LOW KICKPOINT**  
Revised kickpoint profile with softer hosel and top shaft making your shots easier to load.

**SHAFT TECHNOLOGY**  
**PURE CARBON TECHNOLOGY**  
Developed to offer a robust yet lightweight construction for high-performance stick.

**SHAFT GEOMETRY**  
**ERGONOMIC "E" GEOMETRY**  
Unique ergonomic geometry designed to offer a seamless energy transfer to maximize speed of release.

**BLADE**  
**AGILITY BLADE WITH PEEL-PLY**  
A thinner profile blade that takes stick handling and feel to the next level without any compromise on shots release speed.

**MATERIAL**  
**PURE CARBON SHAFT WITH SIGMATEX BLADE**

**OFFERING**

- SR - 85 / 60"  
P28 / P29 / P90TM
- SR - 75 / 60"  
P28 / P29 / P90TM
- SR - 70 / 60"  
P28 / P29 / P90TM
- INT - 65 / 57"  
P28 / P29 / P90TM
- INT - 55 / 55"  
P28 / P29 / P90TM
- JR - 50 / 54"  
P28 / P29 / P90TM
- JR - 40 / 51"  
P28 / P29 / P90TM

PRODUCT HAS A HOLOGRAPHIC FINISH, COLORS MAY VARY FROM THE PICTURE

HSRC9 - LAUNCH DATE

**NEW**  
HSRC96  
**RIBCOR**  
**96K**  
STICK

SR \$ \_\_\_\_\_  
INT \$ \_\_\_\_\_

**KICKPOINT**  
**LOW KICKPOINT**  
Engineered low kickpoint to help increase release speed on shots..

**SHAFT GEOMETRY**  
**ERGONOMIC "E" GEOMETRY**  
Unique ergonomic geometry designed to offer a seamless energy transfer to maximize speed of release.

**BLADE**  
**ASCENT 2 BLADE**  
An optimized stiffness profile that transitions seamlessly from softer in the heel to extra stiff in the toe for heightened puck feel and quick releases.

**MATERIAL**  
**C6 WEAVE ON BLADE**

**OFFERING**

- SR - 85 / 60"  
P28 / P29
- SR - 75 / 60"  
P28 / P29
- INT - 65 / 57"  
P28 / P29
- INT - 55 / 55"  
P28 / P29

HSRC96 - LAUNCH DATE

**NEW**  
HSRC94  
**RIBCOR**  
**94K**  
STICK

SR \$ \_\_\_\_\_  
INT \$ \_\_\_\_\_  
JR \$ \_\_\_\_\_  
YT \$ \_\_\_\_\_

**KICKPOINT**  
**LOW KICKPOINT**  
Engineered low kickpoint to help increase release speed on shots.

**SHAFT GEOMETRY**  
**ROUNDED "R" GEOMETRY**  
Streamlined shape with rounded corners and concave sides that delivers high performance and ultimate comfort.

**BLADE**  
**COMPOSITE SITFF BLADE**  
Carbon and fiberglass blade designed for great durability.

**OFFERING**

- SR - 85 / 60"  
P29
- SR - 75 / 60"  
P29
- INT - 65 / 57"  
P29
- INT - 55 / 55"  
P29
- JR - 50 / 54"  
P29
- JR - 40 / 51"  
P29
- 30 FLEX / 48"  
P29
- 20 FLEX / 45"  
P29
- 10 FLEX / 42"  
P29

HSRC94 - LAUNCH DATE





# TACKS XF PRO STICK

INTRODUCING THE ALL-NEW REDESIGNED TACKS XF PRO THAT IS SURE TO TURN HEADS ON THE ICE! THESE STICKS DISPLAY A WHOLE NEW LOOK, BUT THEY AREN'T JUST ABOUT STYLE - THEY'VE ALSO BEEN DESIGNED TO DELIVER THE EXCEPTIONAL PERFORMANCE THAT PLAYERS HAVE COME TO EXPECT FROM TACKS STICKS. OUR 'V' SHAPE GEOMETRY AND OPTIMIZED KICKPOINT ALLOW PLAYERS TO REACH UNSEEN LEVELS OF PRECISION & STRENGTH, DELIVERING THE MOST POWERFUL WRIST SHOTS DURING THE GAME.

IN ADDITION TO ITS HELICOID BLADE, THE NEW TACKS STICKS WILL TAKE ADVANTAGE OF ITS SOFT BLADE TO SHOOT BULLETS. THE XF PRO IS SURE TO GIVE PLAYERS THE COMPETITIVE EDGE THEY NEED TO DOMINATE ON THE ICE.

## TECH 001

### MODERN MID KICKPOINT

USING A SOFTER MID-SECTION TO ENSURE MAXIMUM ENERGY STORAGE WHEN LOADING THE STICK, OUR NEW MODERN MID KICKPOINT HAS NOW BEEN OPTIMIZED FOR WRIST SHOTS, ENABLING AGGRESSIVE SHOOTERS WITH EVEN MORE PUCK SPEED AND CONSISTENCY THAN BEFORE.

## TECH 002

### NANOLITE SHIELD CARBON LAYERING TECHNOLOGY

HIGH-PERFORMANCE CARBON LAYERING TECHNOLOGY WHICH CREATES A STICK THAT'S BOTH INCREDIBLY LIGHT AND INCREDIBLY STRONG.

## TECH 003

### SOFT HELICOID BLADE

GAIN THE POWER AND FEEL OF A SOFT BLADE WHILE TAKING ADVANTAGE OF THE HELICOID TECHNOLOGY - AN IMPROVED METHOD TO STACK CARBON LAYERS FOR LONG-LASTING PERFORMANCE.

## TECH 004

### SIGMA ST<sup>P</sup> CARBON

SIGMATEX'S TOP PERFORMANCE WEAVE FOR AN UNMATCHED COMBINATION OF WEIGHT REDUCTION AND DURABILITY.

PRODUCT HAS A HOLOGRAPHIC FINISH,  
COLORS MAY VARY FROM THE PICTURE



NEW

# HSXFP TACKS XF PRO STICK

SR \$ \_\_\_\_\_  
INT \$ \_\_\_\_\_  
JR \$ \_\_\_\_\_  
YT \$ \_\_\_\_\_

### NAMEBAR TAG

**KICKPOINT**  
**MODERN MID KICKPOINT**  
Using a softer mid-section to ensure maximum energy storage when loading the stick, our new modern mid kickpoint has now been optimized for wrist shots, enabling aggressive shooters with even more puck speed and consistency than before.

**SHAFT TECHNOLOGY**  
**NANOLITE SHIELD CARBON LAYERING TECHNOLOGY**  
High-performance carbon layering technology which creates a stick that's both incredibly light and incredibly strong.

**SHAFT GEOMETRY**  
**VARIABLE "V" GEOMETRY**  
Variable shaft geometry allowing for an easier and constant loading of the stick to help increase wrist shot power. Its shape transitions along the shaft ensures maximum comfort and grip.

**TAPER TECHNOLOGY**  
**SKELETON +**  
Manufacturing technology found in the taper area which provides better reliability in key moments of the game.

**BLADE**  
**SOFT HELICOID BLADE**  
Gain the loading capacity and feel of a soft blade while taking advantage of the Helicoid technology - an improved method to stack carbon layers for long-lasting performance.

**GRIP**  
**SUPERFAST MICROFEEL**  
Graphic-integrated raised grip on mid-section of the shaft to ensure perfect stick control.

**MATERIAL**  
**SIGMA STP SPREAD TOW SHAFT AND BLADE**

### OFFERING

SR - 95 / 62" P28 / P29  
SR - 85 / 60" P28 / P29 / P90TM  
SR - 80 / 60" P28 / P29 / P90TM  
SR - 75 / 60" P28 / P29 / P90TM  
SR - 70 / 60" P28 / P29 / P90TM  
INT - 65 / 57" P28 / P29 / P90TM  
INT - 55 / 55" P28 / P29 / P90TM

JR - 50 / 54" P28 / P29 / P90TM  
JR - 40 / 51" P28 / P29 / P90TM  
YT - 30 / 48" P28

**BOOKING ONLY**  
SR ONLY - 85 / 80 / 75 / 70  
P28M / P29M

PRODUCT HAS A HOLOGRAPHIC FINISH, COLORS MAY VARY FROM THE PICTURE

HSXFP - LAUNCH DATE

NEW

# HSXF TACKS XF STICK

SR \$ \_\_\_\_\_

### NAMEBAR TAG

**KICKPOINT**  
**MODERN MID KICKPOINT**  
Using a softer mid-section to ensure maximum energy storage when loading the stick, our new modern mid kickpoint has now been optimized for wrist shots, enabling aggressive shooters with even more puck speed and consistency than before.

**SHAFT TECHNOLOGY**  
**PURE CARBON TECHNOLOGY**  
Developed to offer a robust yet lightweight construction for high-performance stick.

**SHAFT GEOMETRY**  
**VARIABLE "V" GEOMETRY**  
New shaft geometry allowing for an easier and constant loading of the stick to help increase wrist shot power. Its shape transition along the shaft ensures maximum comfort and grip.

**TAPER TECHNOLOGY**  
**SKELETON +**  
Manufacturing technology found in the taper area which provides better reliability in key moments of the game.

**BLADE**  
**ACUFEEL BLADE WITH PEEL-PLY**  
Perfected to achieve the right blend of stiffness and feel, the ACUFEEL blade is stiff enough to deliver accuracy and control, yet softer to improve puck feel.

**MATERIAL**  
**PURE CARBON SHAFT WITH SIGMATAX BLADE**

### OFFERING

SR - 85 / 60" P28 / P29 / P90TM  
SR - 80 / 60" P28 / P29 / P90TM  
SR - 75 / 60" P28 / P29 / P90TM  
SR - 70 / 60" P28 / P29 / P90TM

HSXF - LAUNCH DATE

NEW

# HSXF70 TACKS XF-70 STICK

SR \$ \_\_\_\_\_  
INT \$ \_\_\_\_\_  
JR \$ \_\_\_\_\_

**KICKPOINT**  
**MID KICKPOINT**  
Built with a soft mid-section for longer loading periods to store maximum energy, plus a stiff taper zone to boost stability and response.

**SHAFT GEOMETRY**  
**SQUARE "T" GEOMETRY**  
This proven square-shaped design provides players with a traditional feel that provides great grip and control.

**BLADE**  
**UAF BLADE WITH GRIT FINISH**  
Lightweight blade with high torsional and bending stiffness for accurate shooting and passing.

### OFFERING

SR - 85 / 60" P28 / P29  
SR - 75 / 60" P28 / P29  
INT - 65 / 57" P28 / P29  
INT - 55 / 55" P28 / P29

JR - 50 / 54" P28 / P29  
JR - 40 / 51" P28 / P29

HSXF70 - LAUNCH DATE



# JETSPEED FT7 PRO STICK

WHETHER YOU'RE A SNIPER LOOKING TO SCORE FROM THE TOP OF THE CIRCLE OR A PLAYMAKER LOOKING TO CREATE SCORING CHANCES FOR YOUR TEAMMATES, YOU WILL LOVE THE NEW JETSPEED FT7 PRO WITH ITS TRUSTED HYBRID KICKPOINT AND NEW X-SOFT BLADE WITH HELICOID TECHNOLOGY. MADE FROM A PROVEN METHOD OF STACKING CARBON LAYERS, THIS BLADE IS ENGINEERED TO WITHSTAND EVEN THE TOUGHEST ABUSE ON THE ICE, WHILE ENABLING NEW LEVELS OF CONTROL AND FEEL WHEN PASSING OR HANDLING THE PUCK. THIS BLADE CAN TAKE IT ALL AND KEEP PERFORMING AT THE HIGHEST LEVEL. SO IF YOU WANT TO BE A HERO ON THE ICE, THIS INCREDIBLY AGILE AND RESPONSIVE STICK WILL GIVE YOU THE SPEED AND MANEUVERABILITY YOU NEED TO STAY AHEAD OF THE COMPETITION.

## TECH 001

### HYBRID KICKPOINT

EXPERIENCE THE ULTIMATE FUSION OF POWER AND ACCURACY WITH THE HYBRID KICKPOINT - DESIGNED TO ELEVATE YOUR GAME TO THE NEXT LEVEL

## TECH 002

### NANOLITE SHIELD CARBON LAYERING TECHNOLOGY

CUTTING-EDGE TECHNOLOGY THAT USES VARIABLE CARBON LAYER THICKNESSES TO CREATE A LIGHTER STICK WITHOUT SACRIFICING ON DURABILITY

## TECH 003

### RR-110 X-SOFT HELICOID BLADE

SOFTEST CCM BLADE NOW LEVERAGING HELICOID TECHNOLOGY, WITH ITS SMALLER INCREMENTS OF CARBON LAYER STACKING TO INCREASE BLADE DURABILITY WHILE SIGNIFICANTLY IMPROVING STICK FEEL WHEN PASSING AND STICKHANDLING.

## TECH 004

### SIGMA ST<sup>P</sup> CARBON

SIGMATEX'S TOP PERFORMANCE WEAVE FOR AN UNMATCHED COMBINATION OF WEIGHT REDUCTION AND DURABILITY

PRODUCT HAS A HOLOGRAPHIC FINISH,  
COLORS MAY VARY FROM THE PICTURE

## HSFT7P JETSPEED FT7 PRO STICK

SR  
INT  
JR  
YT

### NAMEBAR TAG

**KICKPOINT** **HYBRID KICKPOINT**  
Experience the ultimate fusion of power and accuracy with the hybrid kickpoint - designed to elevate your game to the next level.

**SHAFT TECHNOLOGY** **NANOLITE SHIELD CARBON LAYERING**  
Cutting-edge technology that uses variable carbon fiber layers to create a lighter stick without sacrificing on durability.

**SHAFT GEOMETRY** **ROUND "R" GEOMETRY**  
Streamlined shape with rounded corners and concave sides that keeps gaining in popularity. It delivers high performance and ultimate comfort.

**TAPER TECHNOLOGY** **SKELETON +**  
Manufacturing technology found in the taper area which provides better reliability in key moments of the game.

**BLADE** **RR-110 X-SOFT HELICOID BLADE**  
Softest CCM blade now leveraging Helicoid technology, with its smaller increments of carbon layer stacking to increase blade durability while significantly improving stick feel when passing and stickhandling.

**GRIP** **FT MICROFEEL**  
Raised grip added on the bottom edges of on the mid-section of the shaft to ensure perfect stick control.

**MATERIAL** **SIGMA ST<sup>®</sup> SPREAD TOW SHAFT AND BLADE.**

### OFFERING

SR - 95 / 62" P28 / P29	INT - 65 / 57" P28 / P29 / P90TM
SR - 85 / 60" P28 / P29 / P90TM	INT - 55 / 55" P28 / P29 / P90TM
SR - 80 / 60" P28 / P29 / P90TM	JR - 50 / 54" P28 / P29 / P90TM
SR - 75 / 60" P28 / P29 / P90TM	JR - 40 / 51" P28 / P29 / P90TM
SR - 70 / 60" P28 / P29 / P90TM	YT - 30 / 48" P28

**BOOKING ONLY**  
SR ONLY - 85 / 80 / 75 / 70  
P28M / P29M

PRODUCT HAS A HOLOGRAPHIC FINISH, COLORS MAY VARY FROM THE PICTURE

## HSFT7 JETSPEED FT7 STICK

SR  
INT  
JR

### NAMEBAR TAG

**KICKPOINT** **HYBRID KICKPOINT**  
Experience the ultimate fusion of power and accuracy with the hybrid kickpoint - designed to elevate your game to the next level.

**SHAFT TECHNOLOGY** **ADVANCED CARBON MATRIX**  
Performance carbon layering technology now combining with Sigmatex spread tow to offer a lighter yet sturdier stick.

**SHAFT GEOMETRY** **ROUND "R" GEOMETRY**  
Streamlined shape with rounded corners and concave sides that keeps gaining in popularity. It delivers high performance and ultimate comfort.

**TAPER TECHNOLOGY** **SKELETON +**  
Manufacturing technology found in the taper area which provides better reliability in key moments of the game.

**BLADE** **RR-95 SOFT BLADE WITH PEEL-PLY**  
Newly developed soft blade providing perfect mix of feel, shot speed and control.

**GRIP** **FT MICROFEEL (SR/INT)**  
Raised grip added on the bottom edges of on the mid-section of the shaft to ensure perfect stick control.

**MATERIAL** **SIGMATEX SPREAD TOW SHAFT AND BLADE - (SR/INT)  
PURE CARBON TOW SHAFT AND SIGMATEX BLADE - (JR)**

### OFFERING

SR - 85 / 60" P28 / P29 / P90TM	INT - 65 / 57" P28 / P29 / P90TM
SR - 80 / 60" P28 / P29 / P90TM	INT - 55 / 55" P28 / P29 / P90TM
SR - 75 / 60" P28 / P29 / P90TM	JR - 50 / 54" P28 / P29 / P90TM
SR - 70 / 60" P28 / P29 / P90TM	JR - 40 / 51" P28 / P29 / P90TM

PRODUCT HAS A HOLOGRAPHIC FINISH, COLORS MAY VARY FROM THE PICTURE

**HSFTW24  
JETSPEED  
FTW  
STICK**

SR \_\_\_\_\_  
INT \_\_\_\_\_  
JR \_\_\_\_\_

**KICKPOINT**  
**HYBRID KICKPOINT**  
Experience the ultimate fusion of power and accuracy with the hybrid kickpoint - designed to elevate your game to the next level.

**SHAFT TECHNOLOGY**  
**ADVANCED CARBON MATRIX**  
Performance carbon layering technology now combining with SigmateX spread tow to offer a lighter yet sturdier stick.

**SHAFT GEOMETRY**  
**ROUND "R" GEOMETRY**  
Streamlined shape with rounded corners and concave sides that keeps gaining in popularity. It delivers high performance and ultimate comfort.

**TAPER TECHNOLOGY**  
**SKELETON +**  
Manufacturing technology found in the taper area which provides better reliability in key moments of the game.

**BLADE**  
**RR-95 SOFT BLADE WITH PEEL-PLY**  
Newly developed soft blade providing perfect mix of feel, shot speed and control.

**GRIP**  
**FT MICROFEEL (SR/INT)**  
Raised grip added on the bottom edges of on the mid-section of the shaft to ensure perfect stick control.

**MATERIAL**  
SR/INT: SIGMATEX SPREAD TOW SHAFT AND BLADE  
JR: PURE CARBON TOW SHAFT AND SIGMATEX BLADE

**OFFERING**  
PRODUCT HAS A HOLOGRAPHIC FINISH. COLORS MAY VARY FROM THE PICTURE

- SR - 70 / 60"  
P28 / P29
- INT - 65 / 60"  
P28 / P29
- INT - 60 / 58"  
P28 / P29
- INT - 55 / 58"  
P28 / P29
- JR - 50 / 54"  
P28 / P29
- JR - 40 / 51"  
P28 / P29

**HSJ670  
JETSPEED  
FT 670  
STICK**

SR \_\_\_\_\_  
INT \_\_\_\_\_  
JR \_\_\_\_\_

**KICKPOINT**  
**HYBRID KICKPOINT**  
Creates a hinge effect so you can load the stick using a perfect blend of speed and response.

**SHAFT GEOMETRY**  
**ROUND "R" GEOMETRY**  
Streamlined shape with rounded corners and concave sides that keeps gaining in popularity. It delivers high performance and ultimate comfort.

**BLADE**  
**JS4 BLADE WITH PEEL-PLY**  
Redesigned mid-performance stiff blade offering a great balance between puck feel and shot speed.

**MATERIAL** 18K WEAVE BLADE

**OFFERING**

- SR - 85 / 60"  
P28 / P29
- SR - 75 / 60"  
P28 / P29
- INT - 65 / 57"  
P28 / P29
- INT - 55 / 55"  
P28 / P29
- JR - 50 / 54"  
P28 / P29

JR

SR / INT



**HSJ660  
JETSPEED  
FT 660  
STICK**

- SR \_\_\_\_\_
- INT \_\_\_\_\_
- JR \_\_\_\_\_

**KICKPOINT**  
**HYBRID KICKPOINT**  
Creates a hinge effect so you can load the stick using a perfect blend of speed and response.

**SHAFT GEOMETRY**  
**SQUARE "T" GEOMETRY**  
Proven square-shaped design that provides players with a traditional feel for great grip and control.

**BLADE**  
**STIFF BLADE**  
Stiff blade designed to provide speed of every shot.

**OFFERING**

- |                       |                      |
|-----------------------|----------------------|
| SR - 85 / 60"<br>P29  | JR - 50 / 54"<br>P29 |
| SR - 75 / 60"<br>P29  | JR - 40 / 51"<br>P29 |
| INT - 65 / 57"<br>P29 | YT - 30 / 45"<br>P29 |
| INT - 55 / 55"<br>P29 | YT - 20 / 43"<br>P29 |
|                       | YT - 10 / 42"<br>P29 |

**HSJS7Y  
JETSPEED  
FT YOUTH  
STICK**

**SHAFT**  
**YOUTH GEOMETRY**  
Designed to help kids learn how to hold their stick and develop their stickhandling and shooting technique

**BLADE**  
**STIFF COMPOSITE PAINTED BALDE**  
Blade stiffness that helps younger players lift the puck while allowing enough puck feel for stickhandling and passing

**GRIP**  
**FULL GRIP**  
Full grip to help with control and feel.

**OFFERING**

- 30 FLEX / 48"  
P29
- 20 FLEX / 45"  
P29
- 10 FLEX / 42"  
P29



# FT7 PRO CUSTOM COLORS STICKS

## JETSPEED FT7 PRO STICKS

BOOKING ONLY

BLUE - HSFT7PCB  
CHROME - HSFT7PCC

MINIMUM ORDER OF 12 PER COLOR  
WHEN ORDERING.

NAMEBAR TAG

**KICKPOINT** **HYBRID KICKPOINT**  
Experience the ultimate fusion of power and accuracy with the hybrid kickpoint - designed to elevate your game to the next level.

**SHAFT TECHNOLOGY** **NANOLITE SHIELD CARBON LAYERING**  
Cutting-edge technology that uses variable carbon fiber layers to create a lighter stick without sacrificing on durability.

**SHAFT GEOMETRY** **ROUND "R" GEOMETRY**  
Streamlined shape with rounded corners and concave sides that keeps gaining in popularity. It delivers high performance and ultimate comfort.

**TAPER TECHNOLOGY** **SKELETON +**  
Manufacturing technology found in the taper area which provides better reliability in key moments of the game.

**BLADE** **RR-110 X-SOFT HELICOID BLADE**  
Softest CCM blade now leveraging Helicoid technology, with its smaller increments of carbon layer stacking to increase blade durability while significantly improving stick feel when passing and stickhandling.

**GRIP** **FT MICROFEEL**  
Raised grip added on the bottom edges of on the mid-section of the shaft to ensure perfect stick control.

**MATERIAL** **SIGMA ST® SPREAD TOW SHAFT AND BLADE**

**OFFERING**

- |   |  |
|---|--|
| <b>SR - 85 / 60"</b><br>P28 / P29 / P90TM | <b>INT - 65 / 57"</b><br>P28 / P29 / P90TM |
| <b>SR - 80 / 60"</b><br>P28 / P29 / P90TM | <b>INT - 55 / 55"</b><br>P28 / P29 / P90TM |
| <b>SR - 75 / 60"</b><br>P28 / P29 / P90TM | <b>JR - 50 / 54"</b><br>P28 / P29 / P90TM  |
| <b>SR - 70 / 60"</b><br>P28 / P29 / P90TM | <b>JR - 40 / 51"</b><br>P28 / P29 / P90TM  |

PRODUCT HAS A HOLOGRAPHIC FINISH, COLORS MAY VARY FROM THE PICTURE



**HSFTM6  
JETSPEED  
TEAM  
STICK**

SR  
INT

**KICKPOINT**  
**HYBRID KICKPOINT**  
Creates a hinge effect so you can load the stick using a perfect blend of speed and response.

**SHAFT TECHNOLOGY**  
**PURE CARBON TECHNOLOGY**  
Carbon technology helping create a stick that's both light and strong.

**SHAFT GEOMETRY**  
**ROUND "R" GEOMETRY**  
Streamlined shape with rounded corners and concave sides that keeps gaining in popularity. It delivers high performance and ultimate comfort.

**TAPER TECHNOLOGY**  
**SKELETON +**  
Manufacturing technology found in the taper area which provides better reliability in key moments of the game.

**BLADE**  
**JF-90 BLADE WITH PEEL-PLY**  
Lightweight stiff blade designed to give a heightened feel for the puck without compromising on shot speed and control.

**GRIP**  
**FT MICROFEEL**  
Raised grip added on the bottom edges of on the mid-section of the shaft to ensure perfect stick control.

**MATERIAL**  
**PURE CARBON SHAFT WITH SIGMATEX SPREAD TOW BLADE**

**OFFERING**

**SR - 85 / 60"**  
P28 / P29 / P90TM  
**SR - 75 / 60"**  
P28 / P29 / P90TM  
**SR - 70 / 60"**  
P28 / P29 / P90TM

**INT - 65 / 57"**  
P28 / P29 / P90TM  
**INT - 55 / 55"**  
P28 / P29 / P90TM





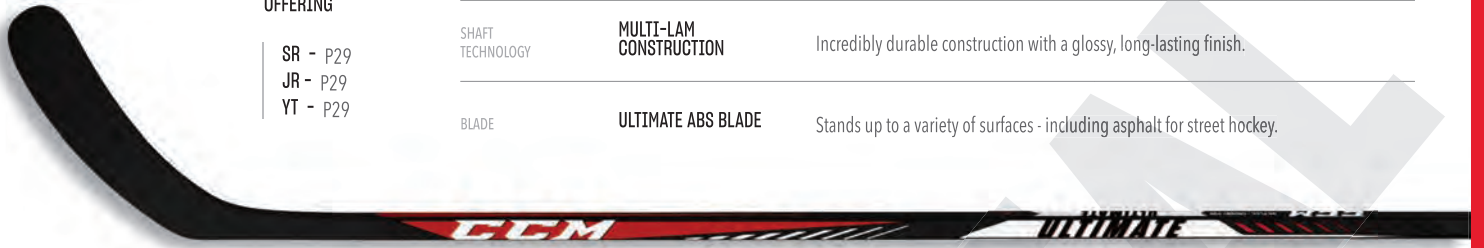

**HSULT**  
**ULTIMATE STICK**

\*ALSO RECOMMENDED FOR STREET HOCKEY

| SR | JR | YT

OFFERING

- SR - P29
- JR - P29
- YT - P29

SHAFT TECHNOLOGY

MULTI-LAM CONSTRUCTION

Incredibly durable construction with a glossy, long-lasting finish.

BLADE

ULTIMATE ABS BLADE

Stands up to a variety of surfaces - including asphalt for street hockey.



**ACCSTKFT7**  
**JETSPEED FT7 PRO**  
**MINI STICK**

CONSTRUCTION	Composite construction
SHAFT	27" Length shaft
SIDE	Left, Right



**ENDPLUFTR - SR**  
**"R" SHAPE END PLUG**

4 inch "R" shape composite endplug

**ENDPLUFTI - INT**  
**"I" SHAPE END PLUG**

4 inch "I" shape composite endplug



**ENDPLU**  
**END**  
**PLUG**

4 inch wood end plug.  
Sizes: SR, JR

**HSNAMEP**  
**NAMEBAR**  
**PRINTER**

A RETAIL TOOL THAT ALLOWS PLAYERS TO HAVE THEIR NAME PERMANENTLY PRINTED ON THEIR STICK, JUST LIKE THE PROS.

**HOW IT WORKS:**

- 1) Simply type in the name of the player.
- 2) Press the printer on the namebar and release the trigger.
- 3) Slowly move the printer downwards.



**HSNAMEI**  
**REPLACEMENT INK CARTRIDGE**

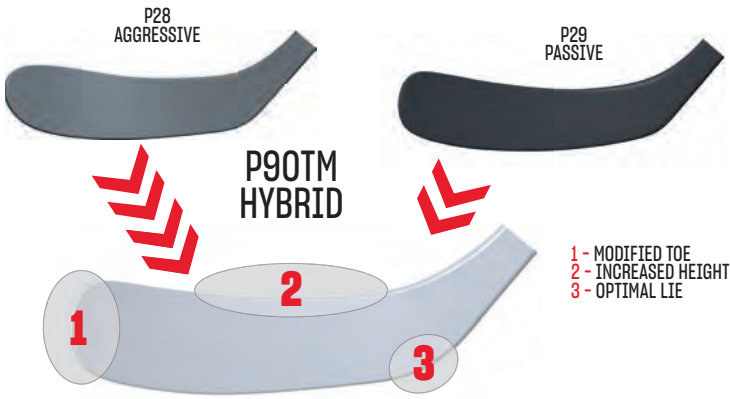

## P90TM CURVE EVALUATION

POPULAR WITH OUR PRO PLAYERS, THE NEW P90TM BLENDS THE P28 AND THE P29 CURVES AND A SUBTLE TOE CURVE. COMBINED WITH A MAX HEIGHT AND A LOWER LIE, THIS IS IDEAL FOR THE PLAYER LOOKING FOR AN EDGE ON FACE-OFFS OR TO HELP TIPPING PUCKS IN THE AIR.

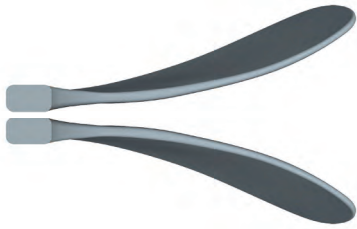

**POSITION** MID/TOE



**SIZE** BIG

**OPENESS** OPENED

### DESCRIPTION

Aggressive curve for players who can shoot from the toe with their hands in front of their body.

### P28 (186-2)

FORMER CCM MCDAVID  
BAUER P28 / WARRIOR W28 /  
EASTON E28 / TRUE TC4

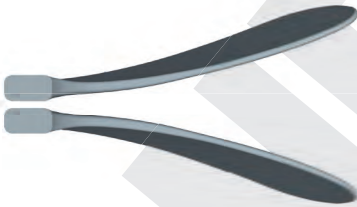

**POSITION** MID

**SIZE** BIG

**OPENESS** OPENED

### DESCRIPTION

All-in-one curve with lower lie for players who are straighter when passing and shooting.

### P29 (203-2)

FORMER CCM CROSBY  
BAUER P92 / WARRIOR W03 / TRUE TC2 /  
EASTON E/P3 / SHERWOOD PP26



**POSITION** MID

**SIZE** BIG

**OPENESS** OPENED

### DESCRIPTION

Perfect blend of P28 aggressive toe and P29 dual lie with a max height feature.

### P90TM (202-2)

## HSRC9P RIBCOR TRIGGER 9 PRO

**NANOLITE SHIELD CARBON LAYERING TECHNOLOGY**  
High-performance carbon layering technology which creates a stick that's both incredibly light and incredibly strong.

**SKELETON + WITH ERGONOMIC "E" GEOMETRY**  
Unique ergonomic geometry designed to offer a seamless energy transfer to maximize speed of release.

**DUAL-FEEL BLADE WITH HELICOID**  
Earn performance, feel and durability with the combination Helicoid & Dual feel.

KEY FEATURES

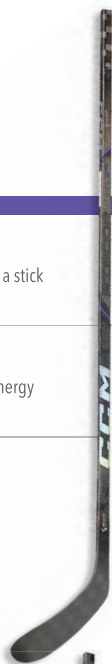

## HSRC9K RIBCOR TRIGGER 9K

**ADVANCED CARBON MATRIX**  
Performance carbon layering technology now combined with Sigmatrix spread tow to offer a lighter yet even more durable stick.

**SKELETON + WITH "E" GEOMETRY**  
Manufacturing technology found in the taper area which provides better reliability in key moments of the game.

**AGILITY BLADE WITH PEEL-PLY**  
A thinner profile blade that takes stick handling and feel to the next level without any compromise on shots release speed.

KEY FEATURES



## HSXFP TACKS XF PRO

**NANOLITE SHIELD CARBON LAYERING WITH SIGMA ST\***  
Cutting-edge technology that uses variable carbon fiber layers to create a lighter stick without sacrificing on durability.

**SKELETON + WITH VARIABLE "V" GEOMETRY**  
New shaft geometry allowing for an easier and constant loading of the stick to help increase wrist shot power. Its shape transitions along the shaft ensures maximum comfort and grip.

**SOFT HELICOID BLADE**  
Gain the loading capacity and feel of a soft blade while taking advantage of the Helicoid technology - an improved method to stack carbon layers for long-lasting performance.

KEY FEATURES

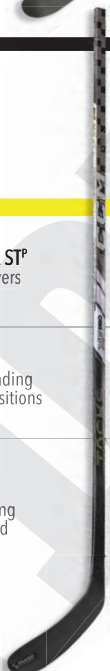

## HSXF TACKS XF

**PURE CARBON TECHNOLOGY**  
Developed to offer a robust yet lightweight construction for high-performance stick.

**SKELETON + WITH VARIABLE "V" GEOMETRY**  
New shaft geometry allowing for an easier and constant loading of the stick to help increase wrist shot power. Its shape transitions along the shaft ensures maximum comfort and grip.

**ACUFEEL BLADE WITH PEEL-PLY**  
Perfected to achieve the right blend of stiffness and feel, the ACUFEEL blade is stiff enough to deliver accuracy and control, yet softer to improve puck feel.

KEY FEATURES



## HSFT7P JETSPEED FT7 PRO

**NANOLITE SHIELD CARBON LAYERING WITH SIGMA ST\***  
Cutting-edge technology that uses variable carbon fiber layers to create a lighter stick without sacrificing on durability.

**SKELETON + WITH "R" GEOMETRY**  
Streamlined shape with rounded corners and concave sides that keeps gaining in popularity. It delivers high performance and ultimate comfort.

**RR-110 X-SOFT HELICOID BLADE**  
Softest CCM blade now leveraging Helicoid technology smaller increments of carbon layer stacking to increase blade durability while significantly improving stick feel when passing and stickhandling.

KEY FEATURES



## HSFT7 JETSPEED FT7

**ADVANCED CARBON MATRIX WITH SIGMATEX CARBON WEAVE**  
Performance carbon layering technology now combining with Sigmatrix spread tow to offer a lighter yet sturdier stick.

**SKELETON + WITH "R" GEOMETRY**  
Manufacturing technology found in the taper area which provides better reliability in key moments of the game

**RR-95 STIFF BLADE WITH PEEL-PLY**  
Improved stiff blade construction for better stick balance and accuracy

KEY FEATURES

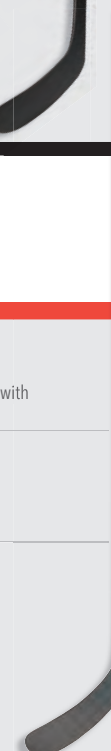



### HSRC9 RIBCOR TRIGGER 9

**PURE CARBON TECHNOLOGY**  
Developed to offer a robust yet lightweight construction for high-performance stick.

**KEY FEATURES**  
**ERGONOMIC "E" GEOMETRY**  
Unique ergonomic geometry designed to offer a seamless energy transfer to maximize speed of release.

**ASCENT 3 BLADE**  
Regular stiffness blade benefitting from construction upgrades for better balance and accuracy.



### HSRC96 RIBCOR 96K

**ERGONOMIC "E" GEOMETRY**  
Unique ergonomic geometry designed to offer a seamless energy transfer to maximize speed of release.

**KEY FEATURES**  
**ASCENT 2 BLADE**  
An optimized stiffness profile that transitions seamlessly from softer in the heel to extra stiff in the toe for heightened puck feel and quick releases.

**C6 WEAVE ON BLADE**



### HSRC94 RIBCOR 94K

**SQUARE "T" GEOMETRY**  
Proven square-shaped design that provides players with a traditional feel for great grip and control.

**KEY FEATURES**  
**COMPOSITE STIFF BLADE**  
Carbon and fiberglass blade designed for great durability.

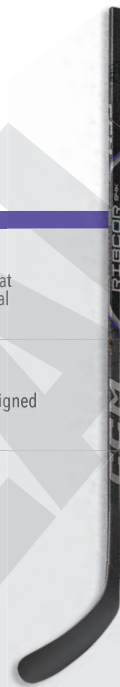

### HSXF70 TACKS XF 70

**SQUARE "T" GEOMETRY**  
This proven square-shaped design provides players with a traditional feel that provides great grip and control.

**KEY FEATURES**  
**UAF BLADE WITH GRIT FINISH**  
Lightweight blade with high torsional and bending stiffness for accurate shooting and passing.



### HSJ670 JETSPEED FT670

**HYBRID KICKPOINT**  
Creates a hinge effect so you can load the stick using a perfect blend of speed and response.

**KEY FEATURES**  
**ROUND "R" GEOMETRY**  
Streamlined shape with rounded corners and concave sides that keeps gaining in popularity. It delivers high performance and ultimate comfort.

**JS4 BLADE WITH PEEL-PLY AND 18K WEAVE**  
Redesigned mid-performance stiff blade offering a great balance between puck feel and shot speed.



### HSJ660 JETSPEED FT660

**SQUARE "T" GEOMETRY**  
Proven square-shaped design that provides players with a traditional feel for great grip and control.

**KEY FEATURES**  
**STIFF BLADE**  
Stiff blade designed to provide speed on every shot.

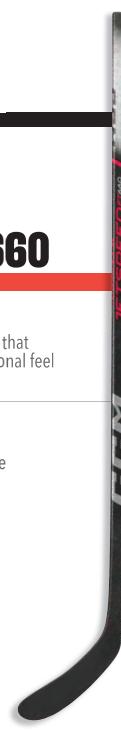

### YOUTH HSJS7Y JETSPEED FT YOUTH

**YOUTH GEOMETRY**  
Designed to help kids learn how to hold their stick and develop their stickhandling and shooting technique

**KEY FEATURES**  
**STIFF COMPOSITE PAINTED BALDE**  
Blade stiffness that helps younger players lift the puck while allowing enough puck feel for stickhandling and passing

**FULL GRIP**  
Full grip to help with control and feel.









**CEM**



***CCM***